









# BUILDING GUIDE

- |  |  |                 |   |  |
|--|--|-----------------|---|--|
|  Accessible Toilets   |  Men's Toilets        | <b>A</b> Door A | <b>D</b> Door D   |  Bristol Beacon Art |
|  Baby Changing Places |  Toilets for Everyone | <b>B</b> Door B | <b>E</b> Door E   |  |
|  Changing Places      |  Women's Toilets      | <b>C</b> Door C |  Lift |  |

**G**

- Lantern**  
 Simons' Bar  
 Story Wall  
**Bridgehouse**  
 Box Office  
 Golding Bar  
 Sound Lounge

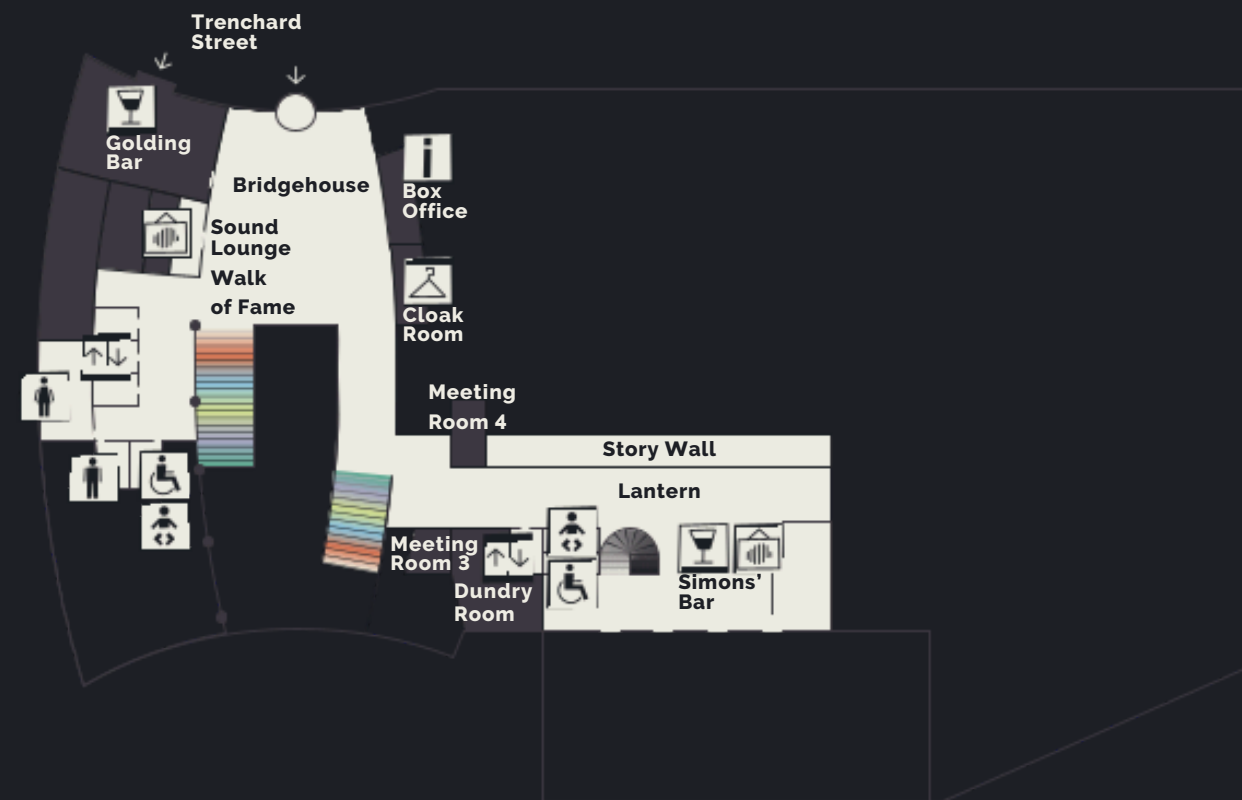

**LG**

- Colonnade**  
**Cellars**  
 Sound Studios  
 Weston Stage  
**Bridgehouse**  
 Bridgehouse Stage  
 Bristol Loaf  
 Kennedy Room



**3**

- Beacon Hall**  
 Foyle Upper Tier  
**Bridgehouse**  
 Terrace Bar & Garden

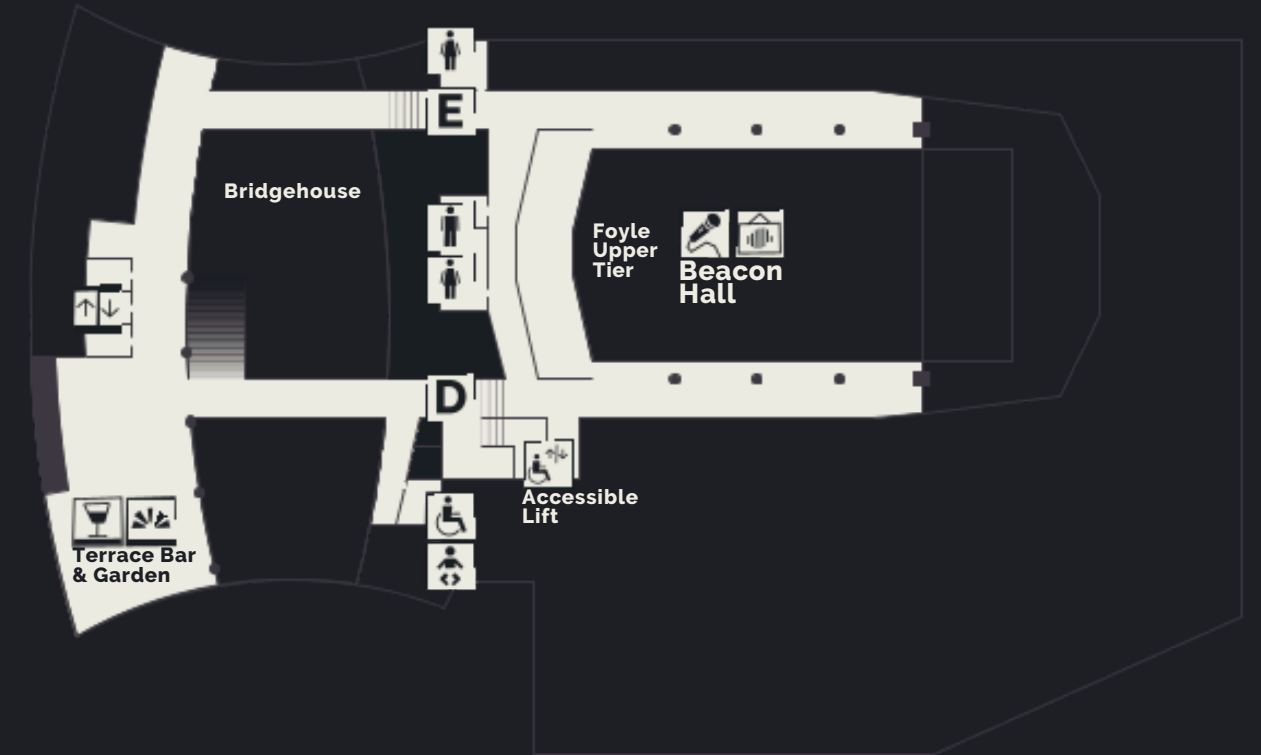

**2**

- Beacon Hall**  
 Lower Tier  
 Choir  
**Bridgehouse**

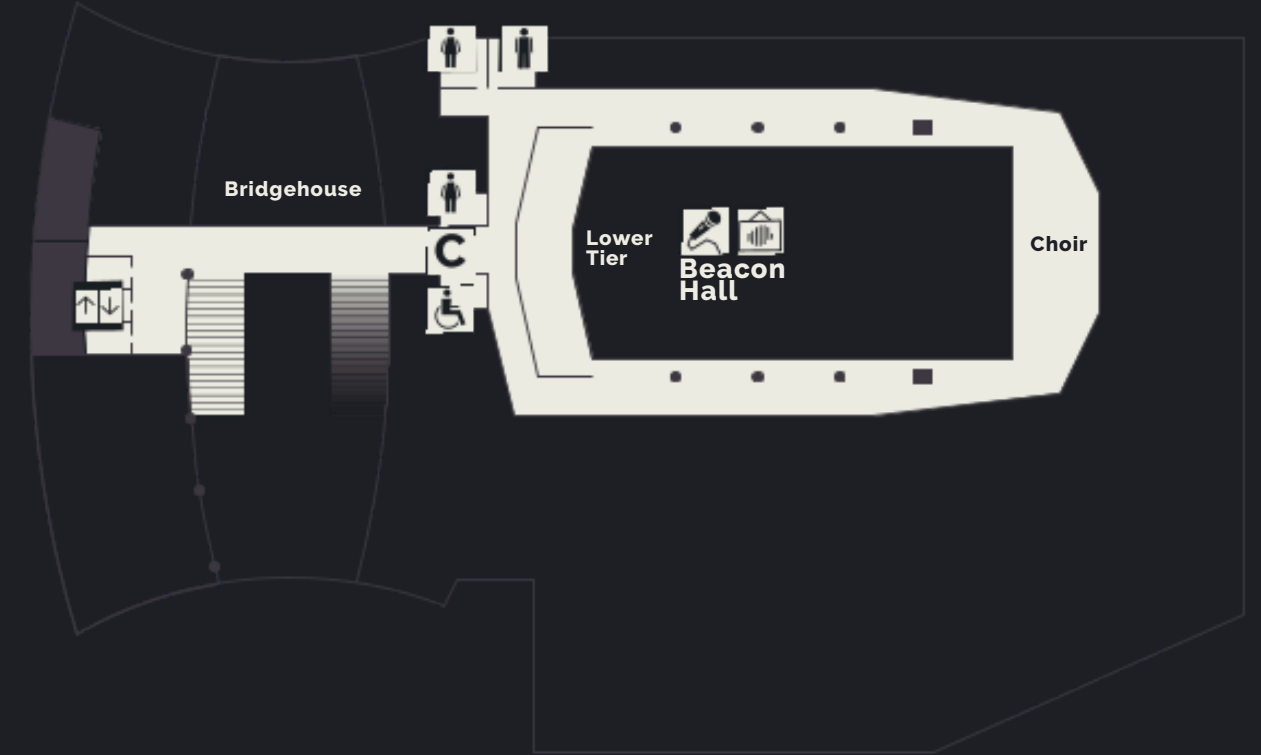

**1**

- Beacon Hall**  
 Stalls  
 Lantern Hall  
**Bridgehouse**  
 Stalls Bar

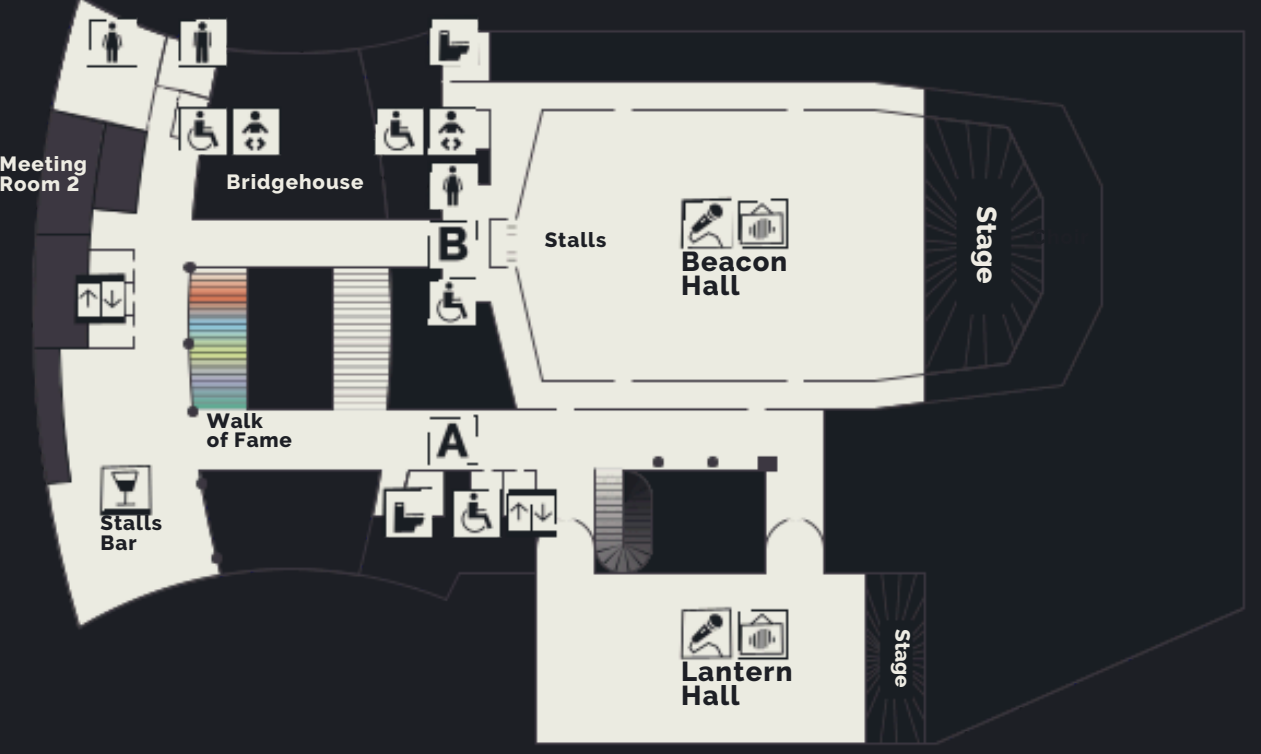

# GROUND FLOOR



## Lantern

Simons' Bar  
Story Wall

## Bridgehouse

Box Office  
Golding Bar  
Sound Lounge

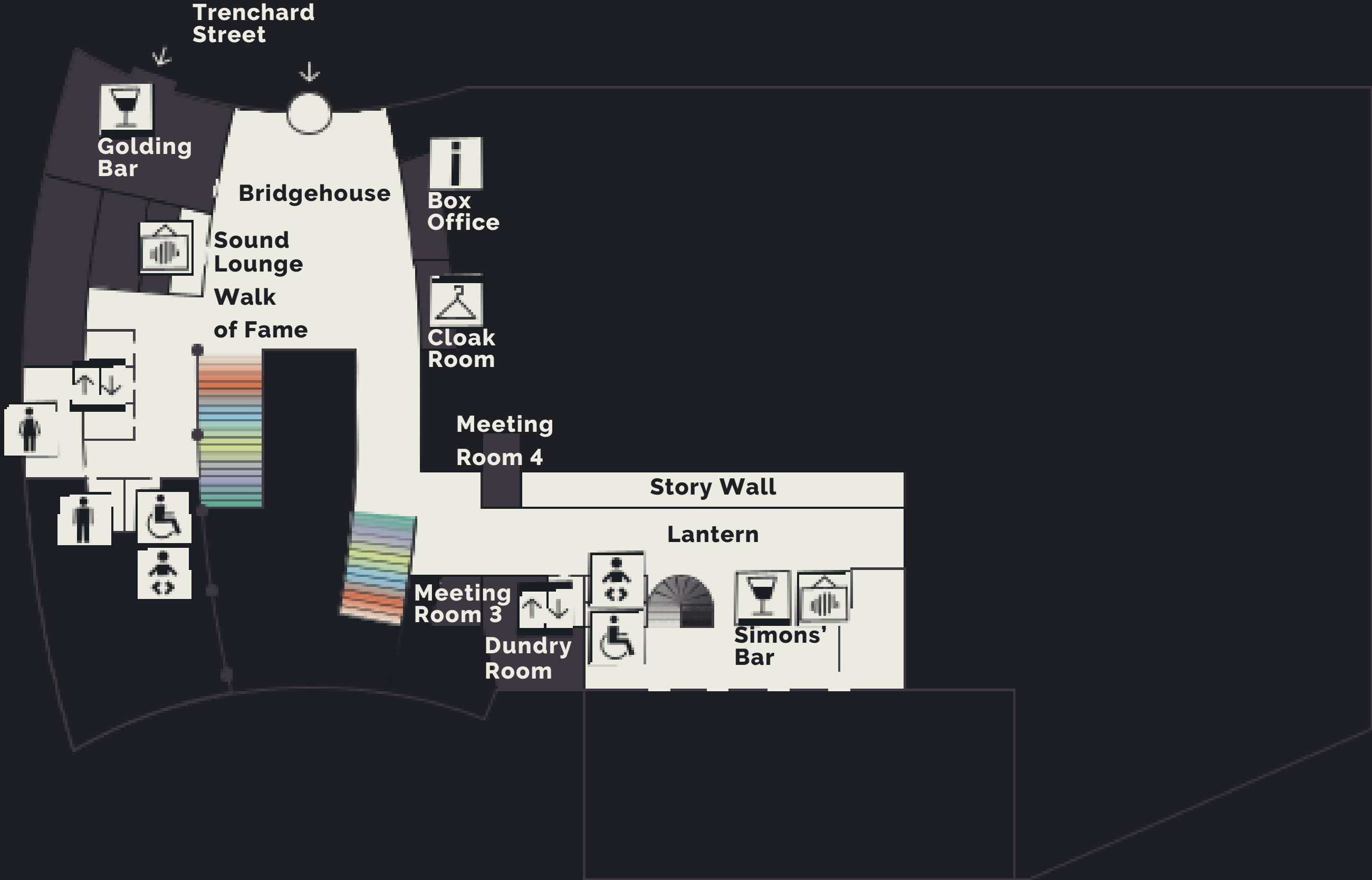

# LOWER GROUND FLOOR



## Colonnade

## Cellars

Sound Studios  
Weston Stage

## Bridgehouse

Bridgehouse Stage  
Bristol Loaf  
Kennedy Room



# LEVEL 1

1

**Beacon Hall**

Stalls

**Lantern Hall**

**Bridgehouse**

Stalls Bar

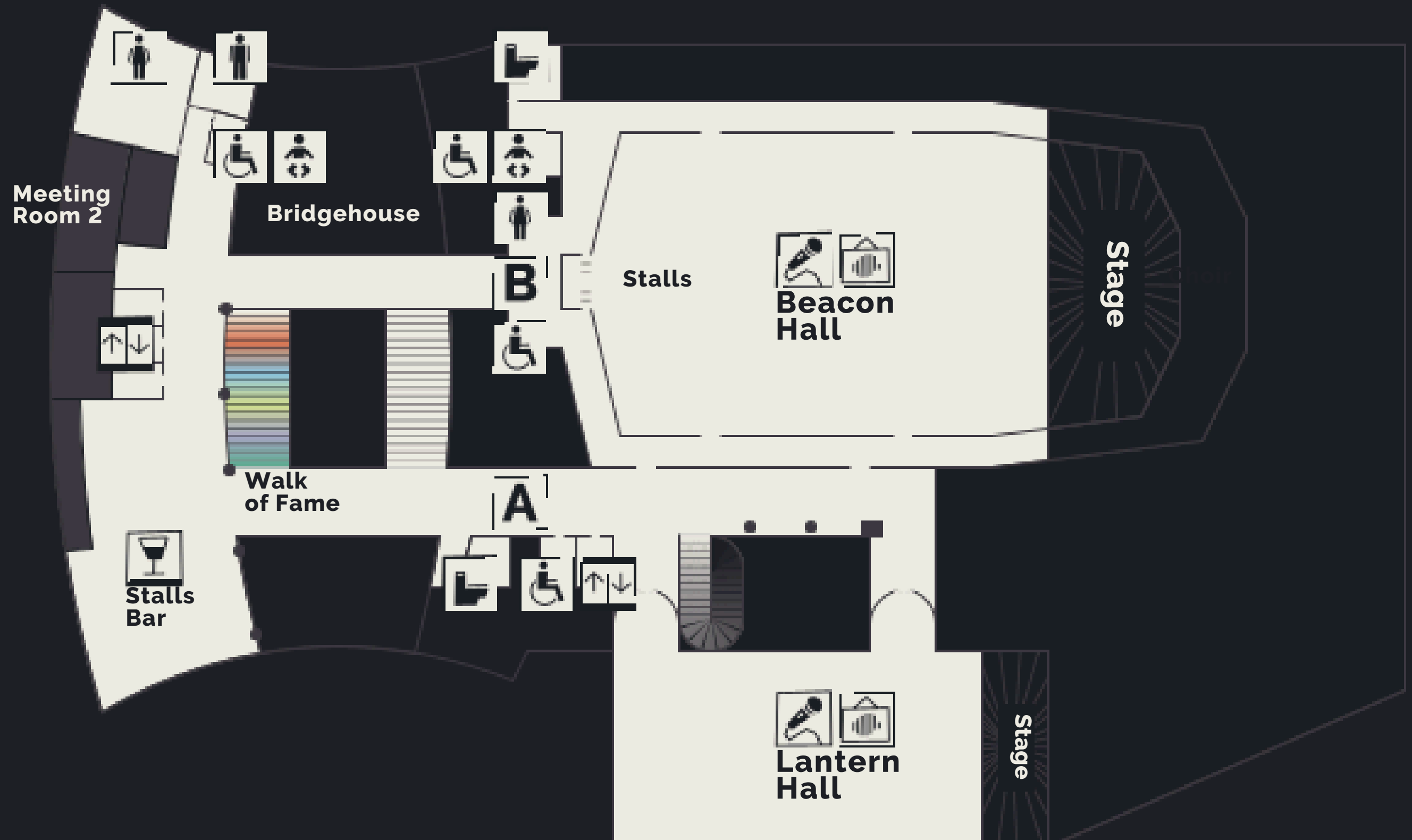

**LEVEL 2**

**2**

**Beacon Hall**

Lower Tier  
Choir

**Bridgehouse**

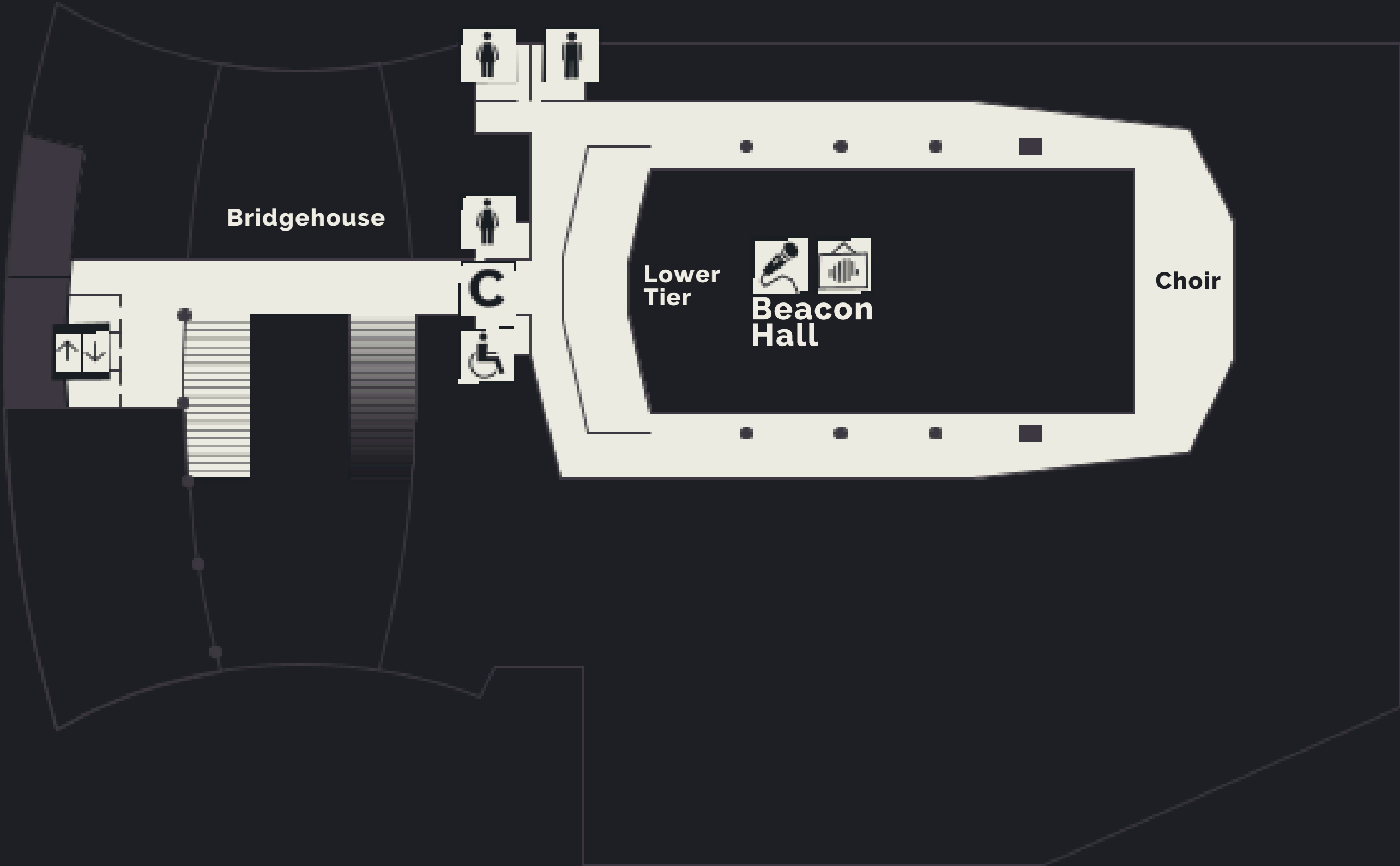

# LEVEL 3

3

## Beacon Hall

Foyle Upper Tier

## Bridgehouse

Terrace Bar & Garden

